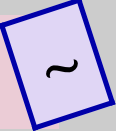

SCAN  ANCHOR

A product from...

SCANOS

HIGH PERFORMANCE TISSUE ANCHOR

A soft tissue titanium bone anchor preloaded on a disposable stainless steel insertion device with two attached independent non-absorbable braided sutures

Scan-Anchor, a unique device incorporating the best historically proven technology upgraded to improve performance in critical areas creating the ultimate in bone anchoring for a most secure fixation

3 sizes available :

Scan-Anchor 28 Ø 2,8 mm

Scan-Anchor 35 Ø 3,5 mm

Scan-Anchor 50 Ø 5,0 mm

Secure grip disposable hex-shaft screwdriver.

Easy to use, protects sutures.



The Scan-Anchors are equipped with a double depth indicator. The distal indicator indicating when the anchor head is embedded and the proximal indicator situated at 10 mm so that the surgeon can evaluate best required anchoring depth.

Sutures are identified by different colours and are in separate eyelets thereby avoiding suture blocking.

The screwdriver handle is transparent to allow for knowing how the sutures are orientated before withdrawing the disposable screwdriver. Sutures orientation is perpendicular to the 'ladder' seen through the anchor handle



Colour code identification

Green for Scan-Anchor 50

Blue for a Scan-Anchor 35

Yellow for Scan-Anchor 28

Distributed by:

CARACTERISTICS OF SUTURES & DEPTH INDICATORS

TWO SAME SIZE COLOUR DIFFERENTIATED SUTURES IN TWO INDEPENDENT EYELETS

Two depth indicators as shown

*Sutures loaded on Scan-Anchor 35 and 50
2 USP size 2 (Ø 0.5 mm) each 80 cm long*

*Sutures loaded on Scan-Anchor 28
2 USP size 2-0 (Ø 0.3 mm) each 60 cm long*

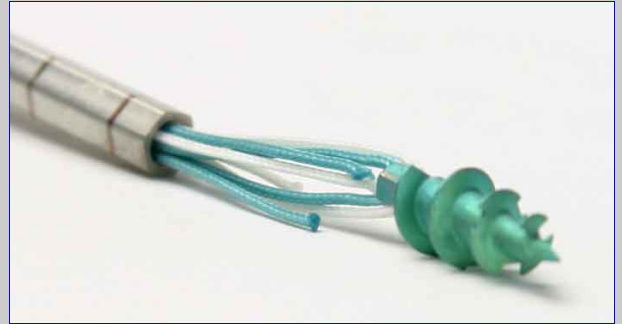

**SUTURES ARE PROTECTED DURING
ANCHOR INSERTION AND LIBERATED
WHEN THE DISPOSABLE INSERTION
DEVICE IS REMOVED.**

ANCHOR CHARACTERISTICS :

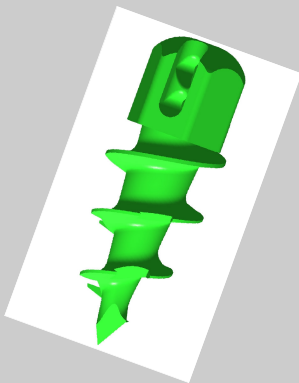

Material : anodised TA6V titanium alloy

*Proximal hex head. Non-traumatic.
Two separate suture eyelets. Ease for suturing.
A cylindrical section. Secure long term fixation.
Self tapping notches. Initial security.
A conical section. Easy penetration and positioning.
Dagger tip. Easy insertion from any angle.
Double depth indicator (3 mm anchor embedded and 10 mm)
Suture orientation indicator through transparent insertion handle*

Order reference	Product description
T35 028	Scan-Anchor 28. Ø 2.8 mm anchor on a disposable insertion device preloaded with 2 USP size 2-0 (Ø 0.3 mm) non-absorbable sutures each 60 cm long
T35 035	Scan-Anchor 35. Ø 3,5 mm anchor on a disposable insertion device preloaded with 2 USP size 2 (Ø 0.5 mm) non-absorbable sutures each 80 cm long.
T35 050	Scan-Anchor 50 Ø 5 mm anchor on a disposable insertion device preloaded with 2 USP 2 (Ø 0.5 mm) non-absorbable sutures each 80 cm long

Material: Anchors, titanium TA6V alloy in compliance to ISO5832-3 standard.
Sutures, braided polyester in compliance to NFS94-167 standard.
Screwdriver hex shaft, medical grade 304L stainless steel.
Screwdriver handle, transparent Fiberglas reinforced ABS.



0499

A Biomed-Scanos Product
☎ : +33.5.61.73.67.16 ☎ : +33.5.61.73.52.35
e-mail : biomed.biomaterials@wanadoo.fr
www.scanos.com

Manufactured by Evolutis S.A.S



Scan-anchor is a registered Trademark sole property of Biomed (France) and a registered design product